

Series MTX 967

TC of ± 10 ppm/ $^{\circ}\text{C}$ to ± 200 ppm/ $^{\circ}\text{C}$, different coatings available

1/1

Good temperature and voltage coefficients, high resistance values and high voltage capability.

Features

- up to 35 kV operating voltage
- Tolerance range $\pm 10\%$ to $\pm 0.1\%$
- Ohmic range $10\ \Omega$ to $30\ \text{G}\Omega$ (depending on model no.)
- Non-Inductive design
- ROHS compliant

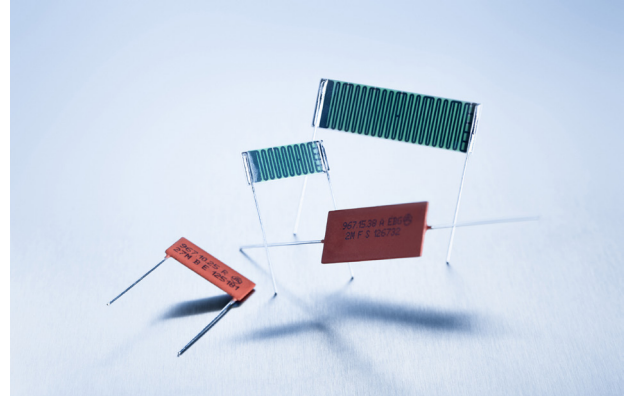

Technical Specifications

Resistance value	$10\ \Omega \leq 30\ \text{G}\Omega$ (depending on model no., ask for details)
Resistance tolerance	$\pm 0.1\%$ to $\pm 10\%$
Temperature coefficient	± 15 ppm/ $^{\circ}\text{C}$ to ± 200 ppm/ $^{\circ}\text{C}$ (at 85°C ref. to $+25^{\circ}\text{C}$) other TCR on special request for limited ohmic values
Max. operating temperature	-55 to $+175^{\circ}\text{C}$
Dielectric strength	$> 1,000\ \text{V}$ (25°C , 75% relative humidity)
Insulation resistance	$> 10,000\ \text{M}$ ($500\ \text{V}$, 25°C , 75% relative humidity)
Overload	$\Delta R/R$ 0.25 % max. $1.5 \times P_{nom}$, 5 sec. (do not exceed $1.5 \times V$ max.)
Load Life	$\Delta R/R$ 0.25 % max.
Moisture resistance	$\Delta R/R$ 0.25 % max.
Thermal shock	$\Delta R/R$ 0.2 % max.
Encapsulation	silicone conformal (U) or glass coating (G) other coatings with different dielectric strengths available on special request
Lead material	tinned copper
Weight	depending on model no. (ask for details)

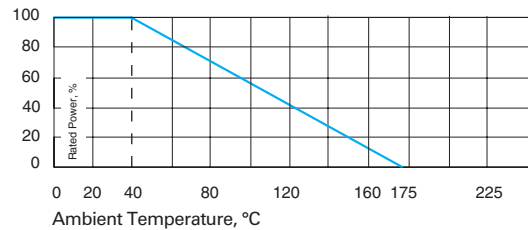

How to make a request

Model no. **A** or **R_U** or **G_Ohmic Value_Tolerance_TCR**

A = Axial
R = Radial

U = Silicone conformal coating
G = Glass coating

For example:

MTX 967.3.25 RG 56M 5% 100ppm or
MTX 967.15.15 AU 1G 1% 100ppm

Model Specifications

Dimensions in mm

Model no.	P Wattage	V kV DC	A (± 1)	B (± 1)	C
967.3.25	1	8	25.4	3.8	22.9
967.3.38	1.5	10	38	3.8	35.7
967.5.13*	1	5	12.7	5.0	10.2
967.5.51	2	20	50.8	5.0	48.3
967.10.25	2	10	25.4	10.0	22.9
967.10.51	3	30	50.8	10.0	48.3
967.15.38	3	15	38	15.0	35.7
967.15.51	4.5	30	50.8	15.0	48.3
967.15.76	5.5	35	76.2	15.0	73.4
967.25.99	10	35	101.6	24.0	98.6

*Pins: $L = 9 + 1\ \text{mm}$

\square $0.6 \times 0.35\ \text{mm}$

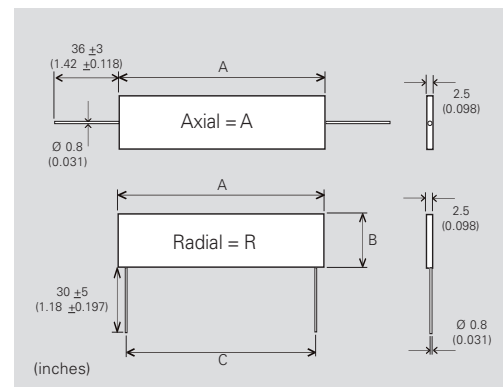



Disclaimer

The given statements and information herein are recommendations for the use of our products and are based on our experience in combination with applicable technical standards.

They are for guidance only and do not represent any assurance of characteristics or warranty commitments for the products or their suitability for specific applications.

The suitability of the products for the intended use by the user depends on different boundary conditions and influencing factors and is to be assessed exclusively by the user.

DISCLAIMER:

NO WARRANTY OR GUARANTEE, EXPRESS OR IMPLIED, IS MADE WITH RESPECT TO THE PRODUCTS, DESIGNS, DATA, INFORMATION DESCRIBED OR ANY INTELLECTUAL PROPERTY CONTAINED THEREIN. ANY WARRANTY OR GUARANTEE OF MERCHANTABILITY OR FITNESS FOR A PARTICULAR PURPOSE IS ALSO EXCLUDED.

The given statements and information herein reflect the current status at the time of publication.

Typing or printing errors cannot be excluded.

This publication shall not be reprinted or reproduced in whole or in part in any form or by any means without the express written permission of Miba Resistors.